

**CO Shutter Lock**

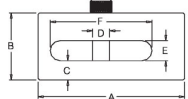

CO Shutter Lock

Model	A	B	C	D	E	F
CO	74	43	12.5	11	13	43
CO-95	95	43	12.5	11	13	66

**Multipurpose Lock**

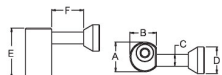

Multipurpose Lock

Model	A	B	C	D	E	F
1116	28	25	11	25	47	18
1130	28	25	11	25	47	30
1135	28	25	11	25	47	35
1140	28	25	11	25	47	40

**M60 , M70**

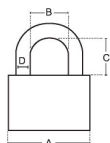

MP Series

Model	A	B	C	D
M60	61	27	48	12.7
M70	71	32	48	12.7

**MP70 (set)**

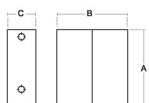

MP70 (set)

Model	A	B	C
MP70	122.5	114	44.5

บริษัท โซล็กซ์ ขอสงวนการเปลี่ยนแปลงรายละเอียดโดยมิได้มีการแจ้งล่วงหน้า

**Container Lock**

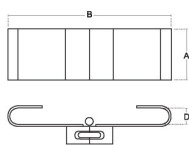

Container Lock

Model	A	B	C
Container Lock	125	400	40

**Trailer Lock**

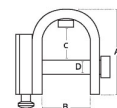
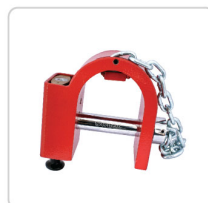

Trailer Lock

Model	A	B	C	D
Trailer Lock	135	78	62.5	22

**Hasp & Hardened Staple**

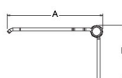

Hasp & Hardened Staple 2 steps

Model	A	B
Hasp & Hardened Staple 2 steps	126	50

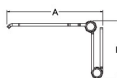

Hasp & Hardened Staple 3 steps

Model	A	B
Hasp & Hardened Staple 3 steps	67	56

**PadLock Bar**

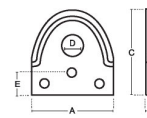

PadLock Bar Model. 68 , 69

Model	A	B	C	D	E
68 Stainless Steel	63	3	68	14	18
69 Hardened Steel	63	5	69	18	18

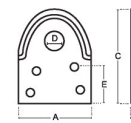

PadLock Bar Model.88

Model	A	B	C	D	E
88	63	5	88	18	34

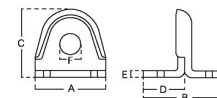

PadLock Bar Model.L60

Model	A	B	C	D	E	F
L60	60	76	60	37	5	18

**Security Padlock Hasp**



Model.70

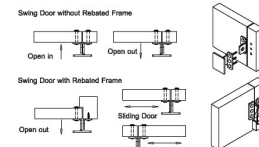

Model.71

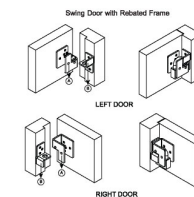

**R-Premium**

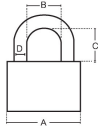

R-Premium

Model	A	B	C	D
R35_CR	37	18	22	7
R40_CR	41	20	23	8
R45_CR	46	22	25	9
R50_CR	51	23	25	10
R55_CR	56	26	27	11
R60_CR	61	28	33	12
R70_CR	71	33	36	12.7



R-Premium L

Model	A	B	C	D
R35L_CRL	37	18	42	7
R40L_CRL	41	20	43	8
R45L_CRL	46	22	45	9
R50L_CRL	51	23	45	10
R55L_CRL	56	26	47	11
R60L_CRL	61	28	51	12
R70L_CRL	71	33	51	12.7

R-Premium XL

Model	A	B	C	D
R35_XL_CRXL	37	18	90	7
R40_XL_CRXL	41	20	90	8
R50_XL_CRXL	51	23	90	10
R60_XL_CRXL	61	28	70	12
R70_XL_CRXL	71	33	70	12.7

**SUS304 Stainless Steel Series for Marine Use**



SUS304 Stainless Steel

Model	A	B	C	D
S40	41	20	23	8
S45	46	22	25	9
S50	51	23	25	10
S60	61	28	33	12

SUS304 Stainless Steel - L

Model	A	B	C	D
S40L	41	20	43	8
S45L	46	22	45	9
S50L	51	23	45	10
S60L	61	28	51	12

**Mach II Plus**



Mach II Plus

Model	A	B	C	D
Mach II 30_CR	31	16	21	5
Mach II 35_CR	37	18	22	7
Mach II 40_CR	41	20	23	8
Mach II 45_CR	46	22	25	9
Mach II 50_CR	51	23	25	10
Mach II 55_CR	56	26	27	11
Mach II 60_CR	61	28	33	12

Mach II Plus L

Model	A	B	C	D
Mach II 30L_CRL	31	16	51	5
Mach II 35L_CRL	37	18	42	7
Mach II 40L_CRL	41	20	43	8
Mach II 45L_CRL	46	22	45	9
Mach II 50L_CRL	51	23	45	10
Mach II 55L_CRL	56	26	47	11
Mach II 60L_CRL	61	28	51	12

**D-Series (Double Keys Padlock)**



D-Series

Model	A	B	C	D
D40	41	20	23	8
D45	46	22	25	9
D50	51	23	25	10
D55	56	26	27	11
D60	61	28	37	12

D-Series L

Model	A	B	C	D
D40	41	20	43	8
D45	46	22	45	9
D50	51	23	45	10
D55	56	26	47	11
D60	61	28	55	12

**F-Series (French Padlock)**

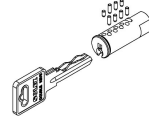

F-Series

Model	A	B	C	D
F-55	55	32	35	9
F-65	65	39	40	10
F-75	75	45	45	12
F-85	85	52	54	12.7

**NO.300**



NO.300

Model	A	B	C	D
40	41	21	24	7
50	51	26	30	9
60	61	33.8	35	10

NO.300 L

Model	A	B	C	D
40L	41	21	44	7
50L	51	26	44	9

**Combination Padlock**

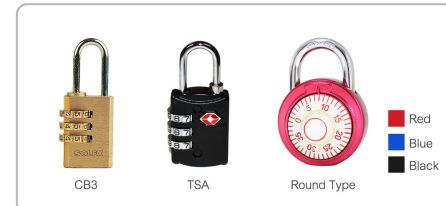

CB3

TSA

Round Type

- Red
- Blue
- Black

**SL99**

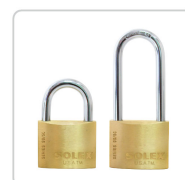

SL 99

Model	A	B	C	D
SL99/20	20	10	13	3.5
SL99/25	25	12.3	15.6	4.25
SL99/30	30	16	17.2	5
SL99/40	40	22	22	6
SL99/50	50	28	28	8
SL99/60	60	30	34	10

SL 99 L

Model	A	B	C	D
SL99/30L	30	16	39	5
SL99/40L	40	22	43	6
SL99/50L	50	28	45	8

**LM-Series (Laminated Padlock)**



LM-Series

Model	A	B	C	D
LM40	40	20	25	6
LM45	45	21	26	7
LM50	50	24	29	8.8
LM65	65	30	35	11

LM-Series L

Model	A	B	C	D
LM40L	40	20	52	6
LM45L	45	21	57	7
LM50L	50	24	65	8.8

**LM Weather Proof Padlock**

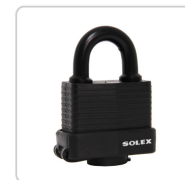

LM Weather Proof

Model	A	B	C	D
LM40WP	44	19	28	7
LM50WP	54	23	29	9.7
LM65WP	69	28	33	12.5

**H-Series (Hammer Padlock)**



H - Hammer Padlock

Model	A	B	C	D
H40	40	21	21	8
H50	50	27	25	7
H60	60	31	31	9
H70	70	34	33	11
H80	80	40	42	11

**CU Series**

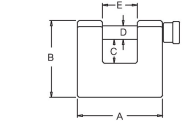

CU

Model	A	B	C	D	E
CU40	40	40	9	8	14
CU50	50	45	13	8	20.5
CU60	60	50	16	10	24.5

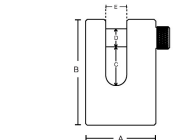

CU Shutter Lock

Model	A	B	C	D	E
CU	43	65	18	11	13

**CU 62/75 , 67/84**



- Hardened Steel
- Stainless Steel
- Brass CR Plated

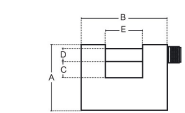

CU Series

Model	A	B	C	D	E
CU 62/75	62	75	12	11	27
CU 67/84	67	84	16.7	12.7	36

**CN 62/78**



- Stainless Steel
- Brass CR Plated

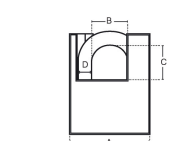

CN Series

Model	A	B	C	D
CN 62/78	62	26	28	11